

Licensing Act 2003  
**Premises Licence**

**LEIPRM1552**



Leicester  
 City Council

Local Services & Enforcement  
 Leicester City Council  
 York House  
 91 Granby Street  
 Leicester  
 LE1 6FB

(0116) 4543040  
[licensing@leicester.gov.uk](mailto:licensing@leicester.gov.uk)

Part 1 - Premises Details

POSTAL ADDRESS OF PREMISES, OR IF NONE, ORDNANCE SURVEY MAP REFERENCE OR DESCRIPTION

**Mamba Bar**

29 Market Street, Leicester, LE1 6DN.

Telephone 3194734

WHERE THE LICENCE IS TIME LIMITED THE DATES

Not applicable

Expires **no expiry**

LICENSABLE ACTIVITIES AUTHORISED BY THE LICENCE

- a performance of live music
- any playing of recorded music
- a performance of dance
- entertainment of a similar description to that falling within a performance of live music, any playing of recorded music or a performance of dance
- provision of late night refreshment
- the supply of alcohol

THE TIMES THE LICENCE AUTHORISES THE CARRYING OUT OF LICENSABLE ACTIVITIES

| Activity (and Area if applicable)   | Description | Time From | Time To  |
|---|-------------|-----------|----------|
| E. Performance of live music (Indoors)  | Mon-Wed     | 11:00am   | 3:00am   |
|   | Thurs-Sat   | 11:00am   | 6:00am   |
|   | Sunday      | 11:00am   | Midnight |
| F. Playing of recorded music (Indoors)  | Mon-Wed     | 11:00am   | 3:00am   |
|   | Sunday      | 11:00am   | Midnight |
|   | Thurs-Sat   | 11:00am   | 6:00am   |
| G. Performance of dance (Indoors)   | Mon-Sat     | 11:00am   | 3:00am   |
|   | Sunday      | 11:00am   | Midnight |
| H. Entertainment of a similar description to that falling within E, F, or G (Indoors) | Mon-Wed     | 11:00am   | 3:00am   |
|   | Thurs-Sat   | 11:00am   | 6:00am   |
|   | Sunday      | 11:00am   | Midnight |
| I. Late night refreshment (Indoors)   | Mon-Sat     | 11:00am   | 3:00am   |
|   | Sunday      | 11:00am   | Midnight |
| J. Supply of alcohol for consumption ON and OFF the premises                          | Mon-Wed     | 11:00am   | 3:00am   |

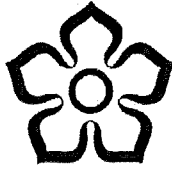

Licensing Act 2003

**Premises Licence****LEIPRM1552**Leicester  
City CouncilLocal Services & Enforcement  
Leicester City Council  
York House  
91 Granby Street  
Leicester  
LE1 6FB(0116) 4543040  
licensing@leicester.gov.uk**THE TIMES THE LICENCE AUTHORISES THE CARRYING OUT OF LICENSABLE ACTIVITIES continued ...**

| Activity (and Area if applicable)  | Description | Time From | Time To  |
|--|-------------|-----------|----------|
| J. Supply of alcohol for consumption ON and OFF the premises continued ... | Thurs-Sat   | 11:00am   | 6:00am   |
|  | Sunday      | 11:00am   | Midnight |
|  |             |           |          |

**THE OPENING HOURS OF THE PREMISES**

| Description | Time From | Time To  |
|-------------|-----------|----------|
| Mon-Wed     | 11:00am   | 3:00am   |
| Thurs-Sat   | 11:00am   | 6:00am   |
| Sunday      | 11:00am   | Midnight |

**WHERE THE LICENCE AUTHORISES SUPPLIES OF ALCOHOL WHETHER THESE ARE ON AND / OR OFF SUPPLIES**

|  |
|--|
| - J. Supply of alcohol for consumption ON and OFF the premises |
|--|

## Part 2

**NAME, (REGISTERED) ADDRESS, TELEPHONE NUMBER AND EMAIL (WHERE RELEVANT) OF HOLDER OF PREMISES LICENCE**

|                   |  |
|-------------------|--|
| Lava Club Limited | 29 Market Street, Leicester, LE1 6DN.<br>Telephone 01162540533 |
|-------------------|--|

**REGISTERED NUMBER OF HOLDER, FOR EXAMPLE COMPANY NUMBER, CHARITY NUMBER (WHERE APPLICABLE)**

|                   |          |
|-------------------|----------|
| Lava Club Limited | 09199892 |
|-------------------|----------|

**NAME, ADDRESS AND TELEPHONE NUMBER OF DESIGNATED PREMISES SUPERVISOR WHERE THE PREMISES LICENCE AUTHORISES THE SUPPLY OF ALCOHOL**

|                      |            |
|----------------------|------------|
| Prabdeep Singh PABLA | [REDACTED] |
|----------------------|------------|

**PERSONAL LICENCE NUMBER AND ISSUING AUTHORITY OF PERSONAL LICENCE HELD BY DESIGNATED PREMISES SUPERVISOR WHERE THE PREMISES LICENCE AUTHORISES FOR THE SUPPLY OF ALCOHOL**

|                         |                    |
|-------------------------|--------------------|
| Licence No. CV219000216 | Issued by Coventry |
|-------------------------|--------------------|



Licensing Act 2003  
**Premises Licence**

**LEIPRM1552**



Leicester  
City Council

Local Services & Enforcement  
Leicester City Council  
York House  
91 Granby Street  
Leicester  
LE1 6FB

(0116) 4543040  
[licensing@leicester.gov.uk](mailto:licensing@leicester.gov.uk)

**ANNEXES**

**Annex 1 - Mandatory conditions**

No supply of alcohol may be made under the premises licence -

- a) at a time when there is no designated premises supervisor in respect of the premises licence, or
- b) at a time when the designated premises supervisor does not hold a personal licence or his personal licence is suspended.

Every supply of alcohol under the premises licence must be made or authorised by a person who holds a personal licence.

The responsible person must ensure that staff on relevant premises do not carry out, arrange or participate in any irresponsible promotions in relation to the premises. In this paragraph, an irresponsible promotion means any one or more of the following activities, or substantially similar activities, carried on for the purpose of encouraging the sale or supply of alcohol for consumption on the premises-

- a) games or other activities which require or encourage, or are designed to require or encourage, individuals to-
  - i) drink a quantity of alcohol within a time limit (other than to drink alcohol sold or supplied on the premises before the cessation of the period in which the responsible person is authorised to sell or supplied alcohol), or
  - ii) drink as much alcohol as possible (whether within a time limit or otherwise);
- b) provision of unlimited or unspecified quantities of alcohol free or for a fixed or discounted fee to the public or to a group defined by a particular characteristic in a manner which carries a significant risk of undermining a licensing objective;
- c) provision of free or discounted alcohol or any other thing as a prize to encourage or reward the purchase and consumption of alcohol over a period of 24 hours or less in a manner which carries a significant risk of undermining a licensing objective;
- d) selling or supplying alcohol in association with promotional posters or flyers on, or in the vicinity of, the premises which can reasonably be considered to condone, encourage or glamorise anti-social behaviour or to refer to the effects of drunkenness in any favourable manner;
- e) dispensing alcohol directly by one person into the mouth of another (other than where that other person is unable to drink without assistance by reason of a disability).

The responsible person must ensure that free potable water is provided on request to customers where it is reasonably available.

The premises licence holder or club premises certificate holder must ensure that an age verification policy is adopted in respect of the premises in relation to the sale or supply of alcohol.

The designated premises supervisor in relation to the premises licence must ensure that the supply of alcohol at the premises is carried on in accordance with the age verification policy.

The policy must require individuals who appear to the responsible person to be under 18 years of age (or such older age as may be specified in the policy) to produce on request, before being served alcohol, identification bearing their photograph, date of birth and either-

- a) a holographic mark, or
- b) an ultraviolet feature.

The responsible person shall ensure that-

- a) where any of the following alcoholic drinks is sold or supplied for consumption on the premises (other than alcoholic drinks sold or supplied having been made up in advance ready for sale or supply in a securely closed container) it is available to customers in the following measures-
  - i) beer or cider: ½ pint;
  - ii) gin, rum, vodka or whisky: 25 ml or 35 ml; and
  - iii) still wine in a glass: 125 ml;
- b) these measures are displayed in a menu, price list or other printed material which is available to customers on the premises; and
- c) where a customer does not in relation to a sale of alcohol specify the quantity of alcohol to be sold, the customer is made aware that these measures are available.

A relevant person shall ensure that no alcohol is sold or supplied for consumption on or off the premises for a price which is less than the permitted price.

**Annex 2 - Conditions consistent with the operating schedule**

The Licence Holder will establish a zero tolerance policy

The Licence Holder will ensure relevant information is shared with local businesses



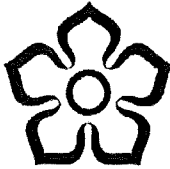

Leicester  
City Council

Local Services & Enforcement  
Leicester City Council  
York House  
91 Granby Street  
Leicester  
LE1 6FB

(0116) 4543040  
[licensing@leicester.gov.uk](mailto:licensing@leicester.gov.uk)

## ANNEXES continued ...

The Licence Holder will complete a premises risk assessment to include the promotion of public safety and the prevention of crime and disorder.

The Licence Holder will ensure there is external lighting outside the premises

The Licence Holder will adopt effective security policies

The Licence Holder will ensure the windows and doors are kept closed other than for entry/ exit from the premises

The Licence Holder will fit a sound limiting device

The Licence Holder will make sure customers queuing for entry to the premises are properly managed

The Licence Holder will adopt a customer dispersal policy

The Licence Holder will maintain a children exclusion policy

### Annex 3 - Conditions attached after a hearing by the Licensing Authority

The licence holder will ensure that Rakesh DHYANI and Yogesh SHARMA will not be involved in the management of the business at 29 Market Street Leicester.

The licence holder will ensure that CCTV is installed following advice from the Leicestershire Police and maintained in accordance with the Commissioners Codes of Practice for CCTV. Recordings will be maintained at all times the premises are open to the public and will be kept for a minimum 31 days.

Recordings will be made available to the police and responsible authorities within 48hours of a request for the recordings being made.

The licence holder will ensure all policies mentioned in the licence conditions are in a written format and made available to the Responsible Authorities on request.

The licence holder will ensure all incidents of Crime and Disorder are reported to the Police and recorded in an incident book to be kept at the premises and made available immediately to Responsible Authorities on request.

The licence holder will provide training to all staff, paid or unpaid, working at the premises in relation to Challenge 21 and will adopt this as the premises 'age policy'. This training is to be documented and repeated a minimum of twice a year to retain focus.

The licence holder will ensure a refusal book is maintained and kept at the premises and made available immediately on request to the Responsible Authorities.

The licence holder will ensure information relating to the venues age policy is displayed in prominent positions for customers and staff around the venue.

The licence holder will inform the Police Licensing officer of any events which are held for customers under the age of 18 and will follow any recommendations given by the police regarding such events.

The licence holder will provide drug awareness training for all staff at the premises, whether paid or unpaid which will be fully documented. The training must include processes to be followed on finding drugs and dealing with persons found in possession of drugs.



Licensing Act 2003

# Premises Licence

# LEIPRM1552

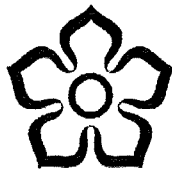

Leicester  
City Council

Local Services & Enforcement  
Leicester City Council  
York House  
91 Granby Street  
Leicester  
LE1 6FB

(0116) 4543040  
[licensing@leicester.gov.uk](mailto:licensing@leicester.gov.uk)

## ANNEXES continued ...

The licence holder will employ SIA registered door staff between the hours of 2200hrs until the venue closes on Friday and Saturday nights and at times when a risk is identified by the licence holder or Responsible Authorities.

The licence holder will ensure the rear door to the premises is used for deliveries and as a fire exit only.

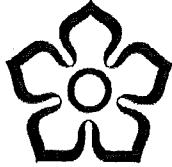

**Premises Licence Summary****LEIPRM1552**

Leicester  
City Council

Local Services & Enforcement  
Leicester City Council  
York House  
91 Granby Street  
Leicester  
LE1 6FB

(0116) 4543040  
[licensing@leicester.gov.uk](mailto:licensing@leicester.gov.uk)

## Premises Details

## POSTAL ADDRESS OF PREMISES, OR IF NONE, ORDNANCE SURVEY MAP REFERENCE OR DESCRIPTION

**Mamba Bar**

29 Market Street, Leicester, LE1 6DN.

Telephone 3194734

## WHERE THE LICENCE IS TIME LIMITED THE DATES

Not applicable

## LICENSABLE ACTIVITIES AUTHORISED BY THE LICENCE

- a performance of live music
- any playing of recorded music
- a performance of dance
- entertainment of a similar description to that falling within a performance of live music, any playing of recorded music or a performance of dance
- provision of late night refreshment
- the supply of alcohol

## THE TIMES THE LICENCE AUTHORISES THE CARRYING OUT OF LICENSABLE ACTIVITIES

| Activity (and Area if applicable)   | Description | Time From | Time To  |
|---|-------------|-----------|----------|
| E. Performance of live music (Indoors)  | Mon-Wed     | 11:00am   | 3:00am   |
|   | Thurs-Sat   | 11:00am   | 6:00am   |
|   | Sunday      | 11:00am   | Midnight |
| F. Playing of recorded music (Indoors)  | Mon-Wed     | 11:00am   | 3:00am   |
|   | Sunday      | 11:00am   | Midnight |
|   | Thurs-Sat   | 11:00am   | 6:00am   |
| G. Performance of dance (Indoors)   | Mon-Sat     | 11:00am   | 3:00am   |
|   | Sunday      | 11:00am   | Midnight |
| H. Entertainment of a similar description to that falling within E, F, or G (Indoors) | Mon-Wed     | 11:00am   | 3:00am   |
|   | Thurs-Sat   | 11:00am   | 6:00am   |
|   | Sunday      | 11:00am   | Midnight |
| I. Late night refreshment (Indoors)   | Mon-Sat     | 11:00am   | 3:00am   |
|   | Sunday      | 11:00am   | Midnight |
| J. Supply of alcohol for consumption ON and OFF the premises                          | Mon-Wed     | 11:00am   | 3:00am   |



## Premises Licence Summary

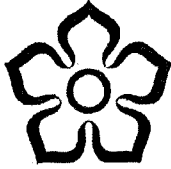

Leicester  
City Council

Local Services & Enforcement  
Leicester City Council  
York House  
91 Granby Street  
Leicester  
LE1 6FB

(0116) 4543040  
[licensing@leicester.gov.uk](mailto:licensing@leicester.gov.uk)

## THE TIMES THE LICENCE AUTHORISES THE CARRYING OUT OF LICENSABLE ACTIVITIES continued ...

| Activity (and Area if applicable)  | Description | Time From | Time To  |
|--|-------------|-----------|----------|
| J. Supply of alcohol for consumption ON and OFF the premises continued ... |             |           |          |
|  | Thurs-Sat   | 11:00am   | 6:00am   |
|  | Sunday      | 11:00am   | Midnight |

## THE OPENING HOURS OF THE PREMISES

| Description | Time From | Time To  |
|-------------|-----------|----------|
| Mon-Wed     | 11:00am   | 3:00am   |
| Thurs-Sat   | 11:00am   | 6:00am   |
| Sunday      | 11:00am   | Midnight |

## WHERE THE LICENCE AUTHORISES SUPPLIES OF ALCOHOL WHETHER THESE ARE ON AND / OR OFF SUPPLIES

- J. Supply of alcohol for consumption ON and OFF the premises

## NAME, (REGISTERED) ADDRESS OF HOLDER OF PREMISES LICENCE

Lava Club Limited

29 Market Street, Leicester, LE1 6DN.

## REGISTERED NUMBER OF HOLDER, FOR EXAMPLE COMPANY NUMBER, CHARITY NUMBER (WHERE APPLICABLE)

Lava Club Limited

09199892

## NAME OF DESIGNATED PREMISES SUPERVISOR WHERE THE PREMISES LICENCE AUTHORISES THE SUPPLY OF ALCOHOL

Prabdeep Singh PABLA

## STATE WHETHER ACCESS TO THE PREMISES BY CHILDREN IS RESTRICTED OR PROHIBITED



# Annex 4 - Plan

This drawing is protected under Copyright and at no time must any portion of this drawing be reproduced or copied in any way without the permission of Nottingham Drawing Services.  
 All dimensions must be checked on site and NOT scaled from this drawing.

SUBJECT TO SITE SURVEY  
 CHECK SURVEY UNDERGARDEN ONLY  
 BEFORE PARAMETERS TAKEN FROM  
 DRAWINGS PROVIDED  
 BUILDING PARAMETERS TAKEN FROM  
 AS BUILT DRAWINGS PROVIDED

STATUS  
 PRE-CONTRACT  APPROVAL COMMENT  
 CONTRACT  AS-BUILT  
 CONSTRUCTION  BUILDINGS CONTROL

| No. | Description | Issue | Date       |
|-----|-------------|-------|------------|
| 01  | AS BUILT    | 1     | 10/10/2014 |

**Nottingham  
 Drawing  
 Services**

3 Telford Road, E. and South of the City Centre, Nottingham, Notts. NG1 1JF  
 Tel: 0115 9510114 Fax: 0115 9510115

Client  
**Lava Club Ltd**

Project  
**LAVA  
 29 MARKET STREET  
 LEICESTER  
 LE1 6DN**

Scale  
**1:100**

Drawn  
**MS**

| Project No. | Sheet No. | Level | Drawing No. | Date |
|-------------|-----------|-------|-------------|------|
|             |           |       | 001         | AB   |

**GROUND FLOOR**

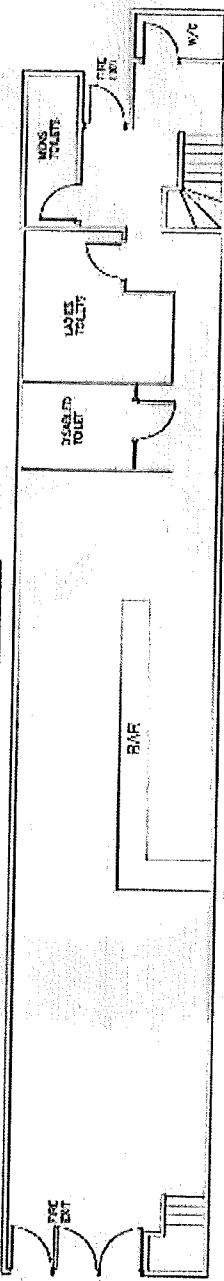

**BASEMENT**

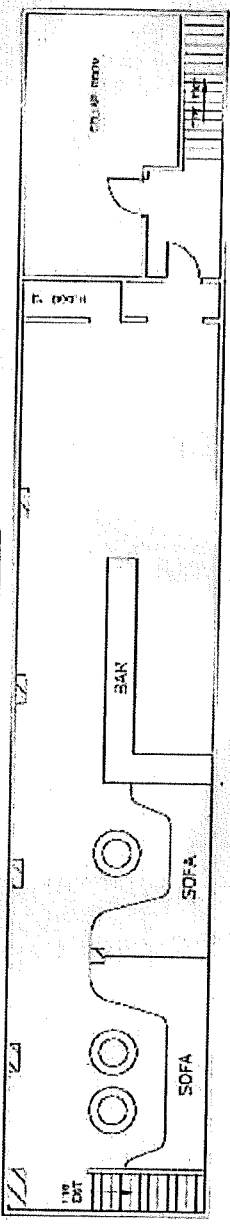

**GROUND & BASEMENT  
 GENERAL LAYOUTS**